

# SAUK RAPIDS-RICE PUBLIC SCHOOLS



---

Informational Session



# Agenda

- Introductions
- The Process
- The Plan
  - » Safety & Security
  - » Long Term Facilities Maintenance Master Plan
  - » Pleasantview Elementary
- Next Steps





## The Process- How did we get here?

- 20 Community Conversations Meetings
- 29 Facilities Listening Session Meetings
- 3 Listening Session Results Meetings
- 3 Facilities Open House/Ice Cream Social Meetings
- Educational Adequacy Assessments
- In-Depth Facility Assessments

**The Sauk Rapids-Rice community  
drove this process!**



# Top Facility Issues From All Listening Sessions:

## **TOP FACILITY ISSUES FROM COMMUNITY LISTENING SESSIONS**

- Do something with Pleasantview
- Utilize current land and building spaces
- Transportation issues: (Traffic flow, parent pick-up and drop-off, younger students and after school activities)
- More Elementary space
- Evaluate Early Childhood space
- Evaluate need for athletic facilities at high school
- Create long-term facilities plan for District

## **TOP FACILITY ISSUES FROM NEIGHBORHOOD LISTENING SESSIONS**

- Do something with Pleasantview
- Get most out of current building spaces
- Need for more Elementary classroom space
- Practical improvements – Needs vs. Wants
- Better utilization of space

## **TOP FACILITY ISSUES FROM INTERNAL DISTRICT STAKEHOLDERS LISTENING SESSIONS**

- Do something with Pleasantview
- More classroom/flexible learning spaces
- Need for more Elementary classroom space
- Improved/additional Special education and calming spaces
- Address Middle School pool
- More Early Childhood space
- Improve traffic flow and pick-up/drop-off

### **Top Facility Issues From Listening Sessions:**

- Do Something with Pleasantview
- More Elementary Space
- More Early Childhood Space
- Address Traffic Flow / Pick Up – Drop Off
- Get Most Out of Current Building and Land Spaces



# Educational Adequacy of District Buildings

CATEGORY		Hillside EC	Hillside ABE	Rice	Mississippi	Pleasantview	Middle	High School
1	Classroom Size and Suitability	R	R	R	Y	R	R	Y
2	Cafeteria/Kitchen/Serving	NA	NA	R	G	R	G	Y
3	Security and Supervision	R	R	R	R	R	R	R
4	Main Office/Nurse/Support Services	Y	R	Y	G	R	G	G
5	Science Classrooms/Labs	NA	NA	Y	G	R	Y	G
6	Art Classrooms/Labs						G	G
7	Music Classrooms/Practice Areas/Etc.	NA	NA	Y	R	Y	G	G
8	Staff Lounge/Collaborative Planning Areas	R	R	Y	G	R	G	G
9	Student Commons/Break-Out Areas	NA	NA	Y	Y	R	G	G
10	Phy Ed./Athletics/Gym/Locker Rooms/Pool Etc.	Y	NA	Y	G	G	G	G
11	Site Suitability: Fields/Green Space/ Storage Etc.	G	G	Y	Y	Y	G	R
12	Parking/Bus Drop-Off: Staff/Students/Parents	R	G	R	Y	R	Y	Y
13	Technology	G	Y	G	G	Y	G	G
14	Library/Media Center: Location/Size/Layout	NA	NA	G	G	R	G	G
15	Special Education/Support Services	R	NA	R	R	R	G	R
16	Auditoriums/Performing Arts Spaces	NA	NA	NA	NA	NA	G	G
17	Career and Technical Education	NA	NA	NA	NA	NA	G	G
18	Hallways/Lockers/Washrooms/Maint. space	R	R	R	R	R	Y	G



# Safety & Security



- Controlled Entrances for Improved Security
- Visitor Management System
- Security Cameras Upgrades & Additions
- Radios

Total Investment: \$4.4 M  
from the Fund Balance

ALREADY UNDERWAY





## Long Term Facilities Needs

Red

**Priority 1 Needs** – Immediate (1-2 Years) Borrow against future LTFM Revenue

Parking Lots, Roofing, Mechanical/Electrical, Energy Efficiency

Yellow

**Priority 2 Needs** – (3-10 Years) LTFM annual allocation

Building Exterior, Parking Lots, Roofing, Interior Finishes, Mechanical/Electrical, Energy Efficiency

Green

**Priority 3 Needs** – (10 + Years) LTFM annual allocation

Building Exterior, Parking Lots, Roofing, Interior Finishes, Mechanical/Electrical

**Total Investment: \$6.6 M from LTFM**

**\* No New Tax Impact**



# Pleasantview Elementary





## Sauk Rapids-Rice Public Schools Enrollment History

### Total K-12 Enrollment History

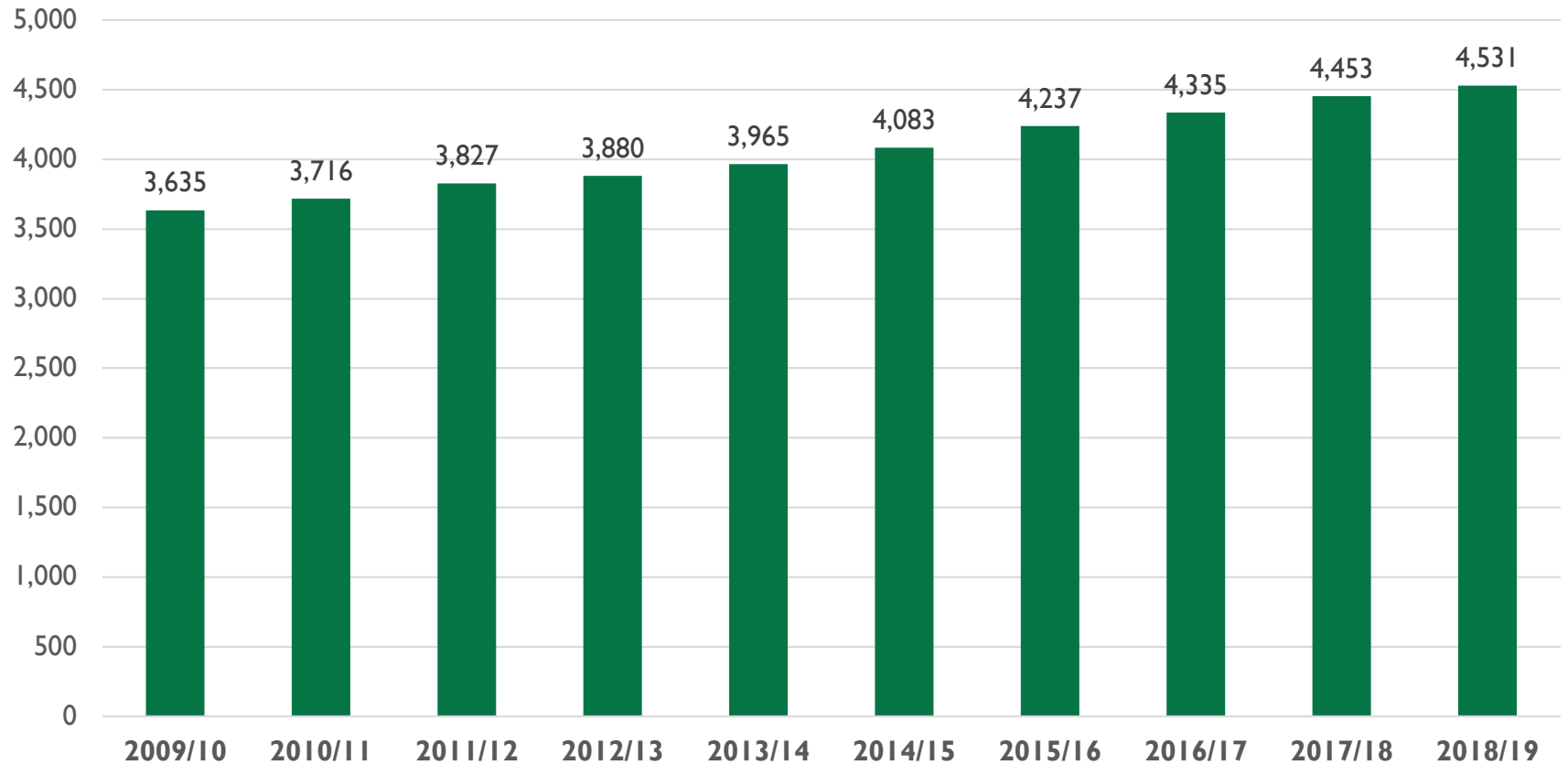



## Open Enrollment

- 8/20/18
  - » School board resolution passed limiting and closing open enrollment.
- 1/28/19
  - » Annual resolution renewed for the 19-20 school year.
  - » District is projecting 50 fewer students in the district for the 19-20 school year.





## Sauk Rapids-Rice Public Schools Projected Enrollment – Resident vs Non-resident

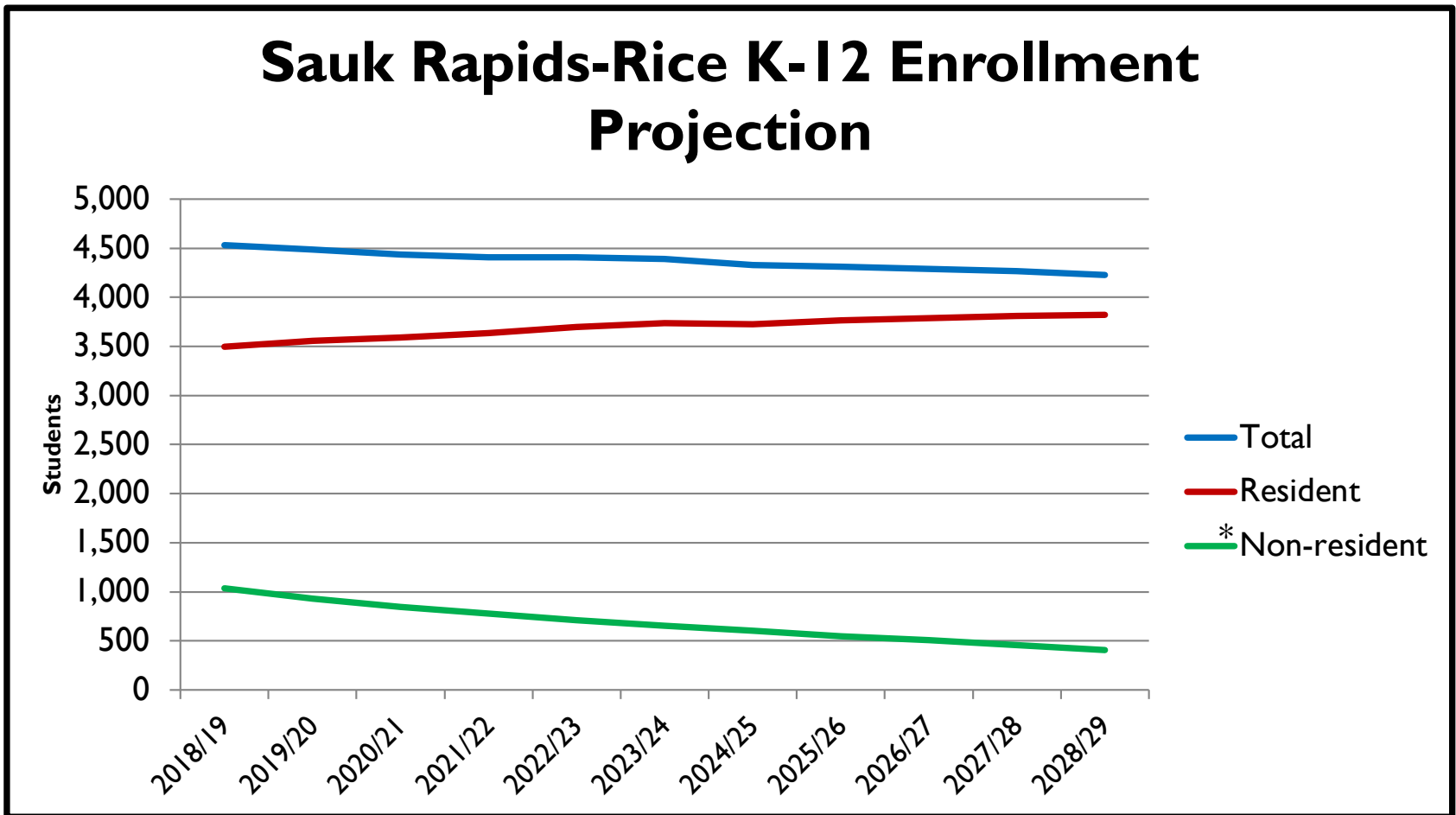

\* Open Enrollment Policy was changed 8/20/18. This change is projected to result in a decrease of non-resident students.



# Pleasantview Elementary New Site Diagram

- **Building capacity:** 797 students
- **Total building size:** 107,595 SF
  - Assumed two story
- **Total parking shown:** 150 stalls
- **Current Pleasantview parking needs:** 133 stalls
  - 118 Staff, 15 visitors
- **Bus parking shown:** 13 buses
- Playground and hard surface play approx. same size as current
- Existing Pleasantview outline shown for reference
- Site-plan allows for future expansion if needed

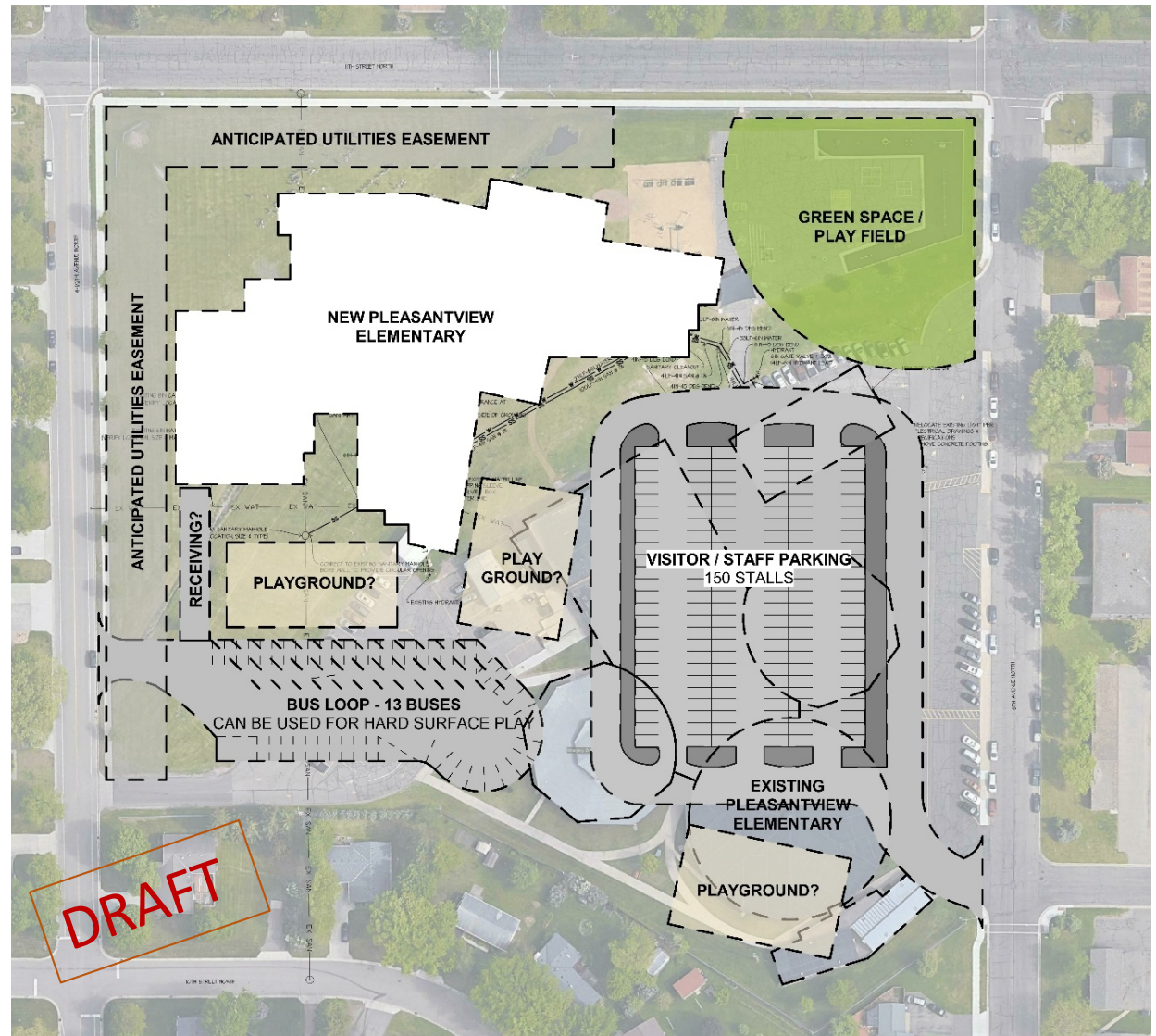



# Pleasantview Elementary

- **Action:**
  - » New 797 student building on current site
- **Budget:** Estimated Cost: \$36,500,000
  - » Budget takes into account construction of new elementary, site improvements (including re-routing utilities) and demolition of existing Pleasantview facility.
- **Funding Source:**
  - » Bond Referendum (tax impact)





# Bond Referendum

	Total Project Cost	Bond Amount	Tax Impact (increase to existing taxes)
Vote on bond issuance for new Pleasantview Elementary on current site	\$36.5 M	\$37.125 M	* \$6.58 per month \$79 per year

\* Tax impact based on estimated tax increase from taxes payable in 2019 to taxes payable in 2020 on a current median home value of \$182,000 (source: Benton County)





# Current Debt

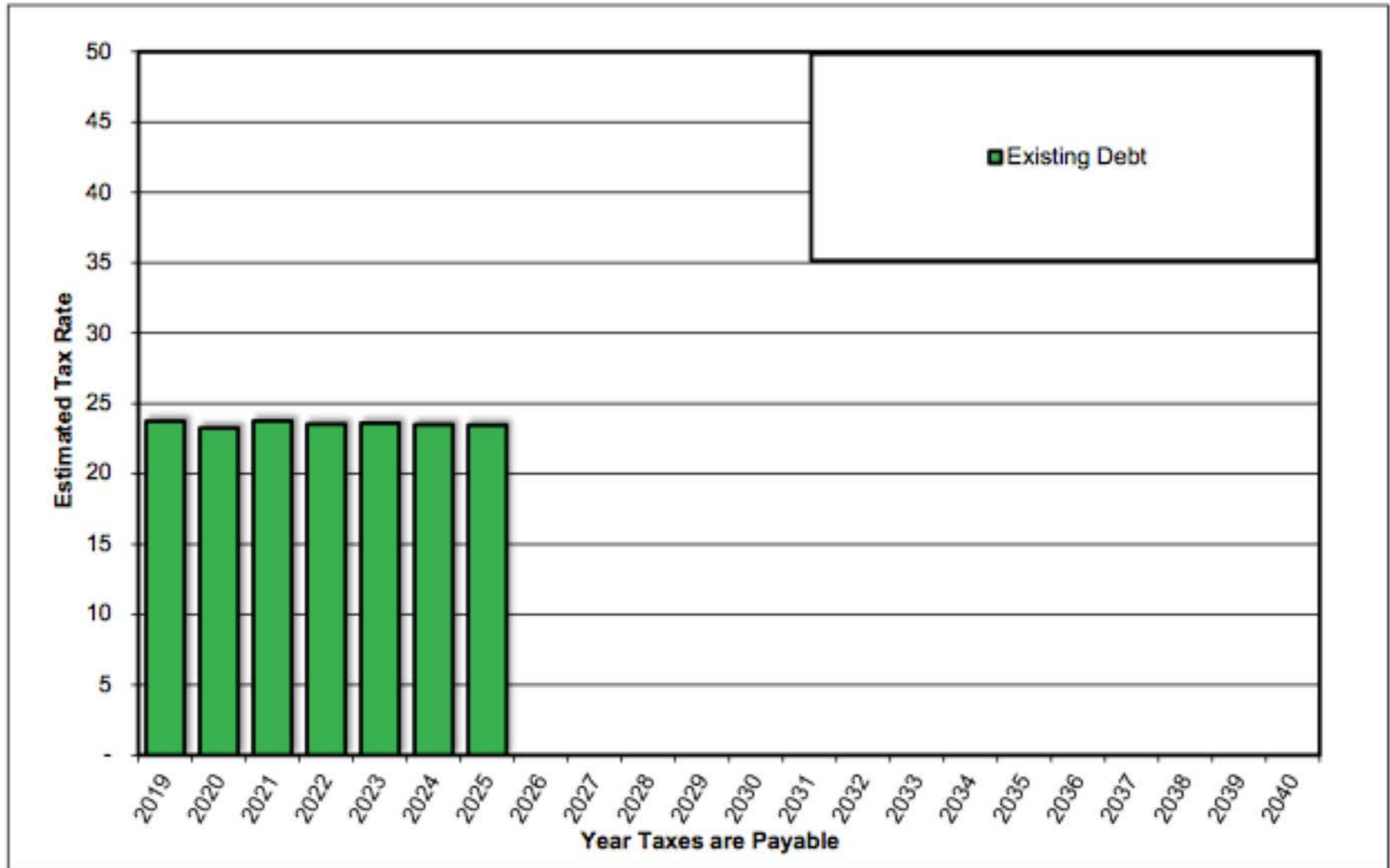



# Proposed Debt Structure

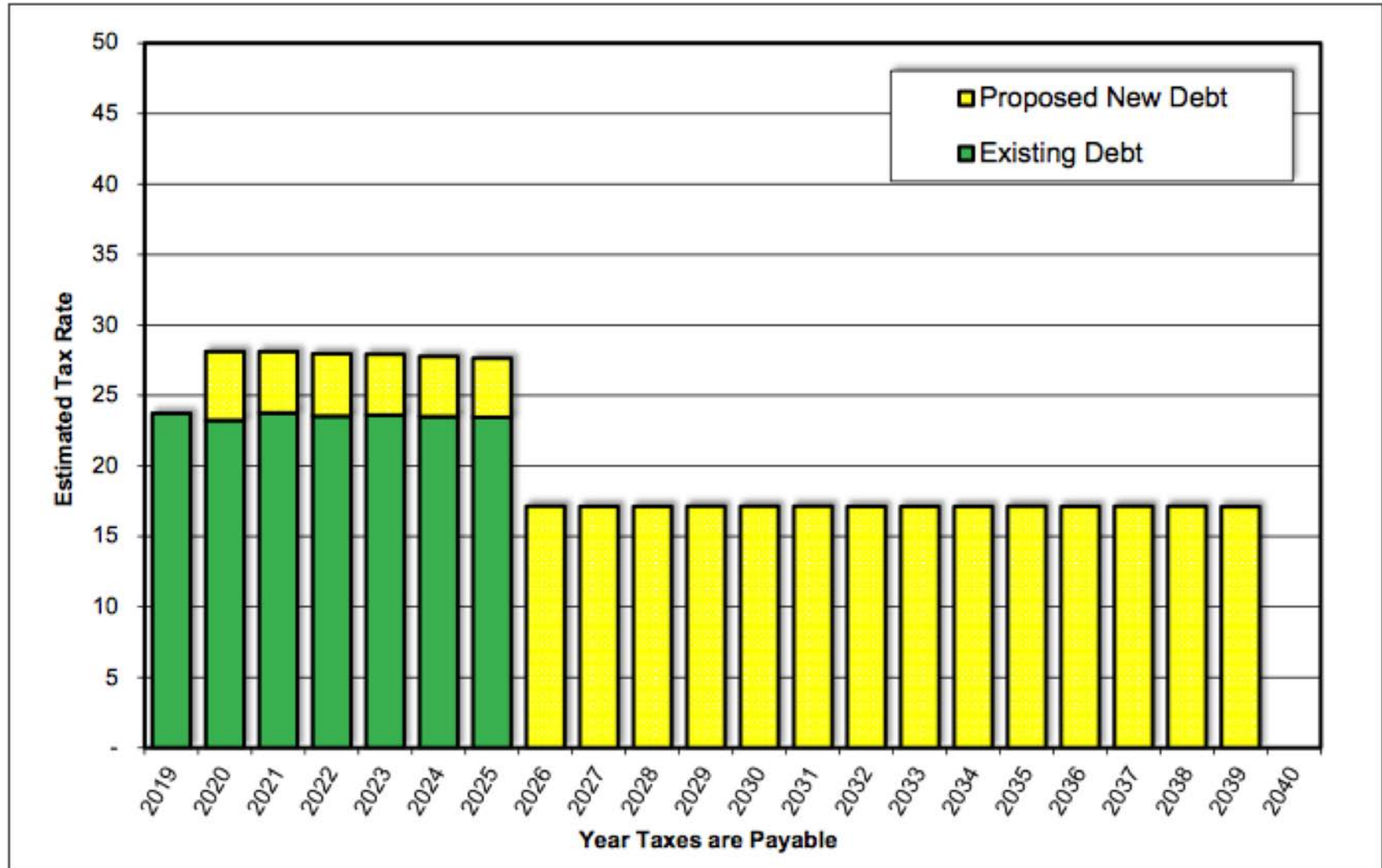



# Pleasantview Educational Adequacy Chart After Proposed Improvements

CATEGORY		EXISTING	NEW
1	Classroom Size and Suitability	R	G
2	Cafeteria/Kitchen/Serving	R	G
3	Security and Supervision	R	G
4	Main Office/Nurse/Support Services	R	G
5/6	Science & Art Class/labs	R	G
7	Music Classrooms/Practice Areas/Etc.	Y	G
8	Staff Lounge/Collaborative Planning Areas	R	G
9	Student Commons/Break-Out Areas	R	G
10	Physical Ed./Athletics/Gym/Locker Rooms/Pool Etc.	G	G
11	Site Suitability: Fields/Green Space/ Storage Etc.	Y	G
12	Parking/Bus Drop-Off: Staff/Students/Parents	R	G
13	Technology	Y	G
14	Library/Media Center: Location/Size/Layout	R	G
15	Special Education/Support Services	R	G
16	Auditoriums/Performing Arts Spaces	NA	NA
17	Career and Technical Education	NA	NA
18	Hallways/Lockers/Washrooms/Maintenance space	R	G



# Districtwide Educational Adequacy Chart Comparison After Proposed Improvements

	CATEGORY	Hillside EC	Hillside ABE	Rice	Mississippi	Pleasantview	Middle	High School
1	Classroom Size and Suitability	R	R	R	Y	R	R	Y
2	Cafeteria/Kitchen/Serving	NA	NA	R	G	R	G	Y
3	Security and Supervision	R	R	R	R	R	R	R
4	Main Office/Nurse/Support Services	Y	R	Y	G	R	G	G
5	Science Classrooms/Labs	NA	NA	Y	G	R	Y	G
6	Art Classrooms/Labs						G	G
7	Music Classrooms/Practice Areas/Etc.	NA	NA	Y	R	Y	G	G
8	Staff Lounge/Collaborative Planning Areas	R	R	Y	G	R	G	G
9	Student Commons/Break-Out Areas	NA	NA	Y	Y	R	G	G
10	Phy Ed./Athletics/Gym/Locker Rooms/Pool Etc.	Y	NA	Y	G	G	G	G
11	Site Suitability: Fields/Green Space/ Storage Etc.	G	G	Y	Y	Y	G	R
12	Parking/Bus Drop-Off: Staff/Students/Parents	R	G	R	Y	R	Y	Y
13	Technology	G	Y	G	G	Y	G	G
14	Library/Media Center: Location/Size/Layout	NA	NA	G	G	R	G	G
15	Special Education/Support Services	R	NA	R	R	R	G	R
16	Auditoriums/Performing Arts Spaces	NA	NA	NA	NA	NA	G	G
17	Career and Technical Education	NA	NA	NA	NA	NA	G	G
18	Hallways/Lockers/Washrooms/Maint. space	R	R	R	R	R	Y	G

**Current**  
(37 reds)

	CATEGORY	Hillside EC	Hillside ABE	Rice	Mississippi	Pleasantview	Middle	High School
1	Classroom Size and Suitability	R	R	R	Y	G	R	Y
2	Cafeteria/Kitchen/Serving	NA	NA	R	G	G	G	Y
3	Security and Supervision	G	Y	G	G	G	G	G
4	Main Office/Nurse/Support Services	Y	R	G	G	G	G	G
5	Science Classrooms/Labs	NA	NA	Y	R	G	Y	G
6	Art Classrooms/Labs						G	G
7	Music Classrooms/Practice Areas/Etc.	NA	NA	Y	Y	G	G	G
8	Staff Lounge/Collaborative Planning Areas	R	R	Y	G	G	G	G
9	Student Commons/Break-Out Areas	NA	NA	Y	Y	G	G	G
10	Phy Ed./Athletics/Gym/Locker Rooms/Pool Etc.	Y	NA	Y	G	G	G	G
11	Site Suitability: Fields/Green Space/ Storage Etc.	G	G	Y	G	G	G	R
12	Parking/Bus Drop-Off: Staff/Students/Parents	R	G	R	G	G	Y	Y
13	Technology	G	Y	G	G	G	G	G
14	Library/Media Center: Location/Size/Layout	NA	NA	G	G	G	G	G
15	Special Education/Support Services	R	NA	Y	R	G	G	R
16	Auditoriums/Performing Arts Spaces	NA	NA	NA	NA	NA	G	G
17	Career and Technical Education	NA	NA	NA	NA	NA	G	G
18	Hallways/Lockers/Washrooms/Main t. space	R	R	R	R	G	Y	G

**Proposed**  
(19 reds)



# Decision Making Flow Chart

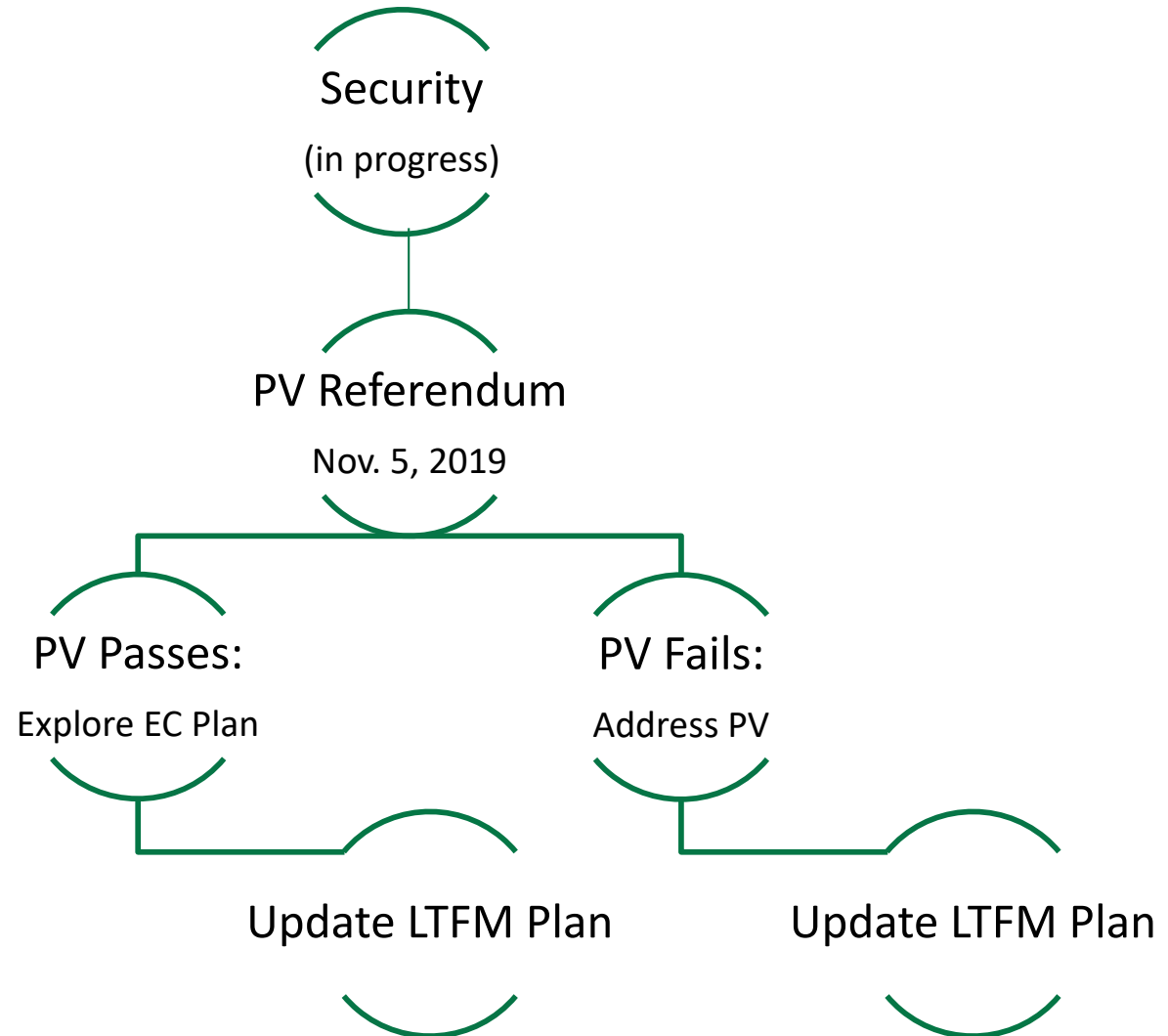



***ONE STORM***



***ONE FUTURE***

**A PLAN FOR ONE STORM, ONE FUTURE**

**More information available at**  
**[www.onestormonefuture.com](http://www.onestormonefuture.com)**

# RESOURCES

## ENSURING YOU STAY INFORMED AND ENGAGED.

Our District will ensure that this website is updated with information that will aid our community members to make an informed vote on Tuesday, November 5, 2019.

### LISTENING SESSION RESULTS

[ONLINE LISTENING  
SESSION](#)[LISTENING  
SESSION RESULTS](#)[VIEW LISTENING SESSION AND EDUCATIONAL  
ADEQUACY SUMMARY](#)

### RESOURCES

[FREQUENTLY ASKED QUESTIONS](#)[FAST FACTS FLYER](#)[FACILITY ASSESSMENT 10 YEAR PLAN BINDER](#)

# THE COST

On Tuesday, November 5, the residents of Sauk Rapids and Rice will decide whether to replace Pleasantview Elementary as the first step in the district's long-term facilities plan.

**THE SINGLE BALLOT QUESTION ASKS FOR \$37.1 MILLION. FOR THE OWNER OF A MEDIAN VALUE HOME IN THE DISTRICT - \$182,000 – THE TAX IMPACT WOULD BE \$6.58 A MONTH.**

## TAX IMPACT CALCULATOR

### Residential Homestead Property

If you own a RESIDENTIAL HOMESTEAD property, enter the Estimated Market Value below to see the estimated tax impact

ESTIMATED MARKET VALUE

*Enter only whole numbers to the nearest dollar  
(no dollar signs, commas, or decimals).*

CALCULATE

### Commercial / Industrial Property

If you own COMMERCIAL/INDUSTRIAL property, enter the Estimated Market Value below to see the estimated tax impact.

ESTIMATED MARKET VALUE

*Enter only whole numbers to the nearest dollar  
(no dollar signs, commas, or decimals).*

CALCULATE



# CONNECT WITH ISD 47



## WE'D LOVE TO HEAR FROM YOU!

Please use the form below to send a message to the District. If you'd rather call, please call Christie at 320.253.4703 Ext. 1809.

Name \*

First Name

Last Name

Email \*



## Extended Voting Dates/Hours

### **Regular Early Voting hours are**

September 20 through November 4

8:00 a.m. - 4:00 p.m. Monday through Friday

### **Extended Voting Dates/Hours**

Tuesday, September 24 from 4:00 p.m. - 6:30 p.m.

Monday, September 30 from 4:00 p.m. - 6:30 p.m.

Wednesday, October 9 from 4:00 p.m. - 6:30 p.m.

Thursday, October 24 from 4:00 p.m. - 6:30 p.m.

Monday, October 28 from 4:00 p.m. - 6:30 p.m.



### **MEA Break**

Wednesday, October 15 through Friday,

October 17 8:00 a.m. - 4:00 p.m.

### **Location**

Sauk Rapids-Rice Public Schools

District Office

1833 Osauka Road NE

Sauk Rapids, MN 56301

Please enter Door 2 and proceed to the  
2nd Floor District Office Suite.



Questions???

